

TA40.T



caratteristiche/features



ø 32



M26



1-1



5000

peso/weight

head



33 kg

extension



L 200=26,5 kg

rotazione/rotation



input



output

prestazioni/performance

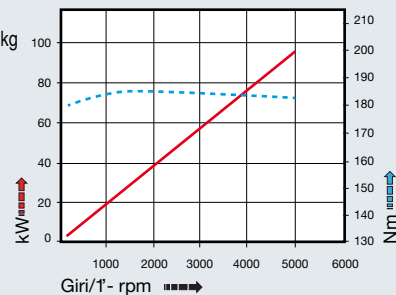

tipi mandrino disponibili / available spindle types

4 DIN69893-HSK
HSK63

5 COROMANT
CAPTO®
C5

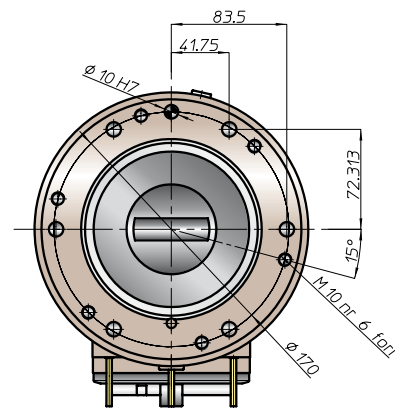
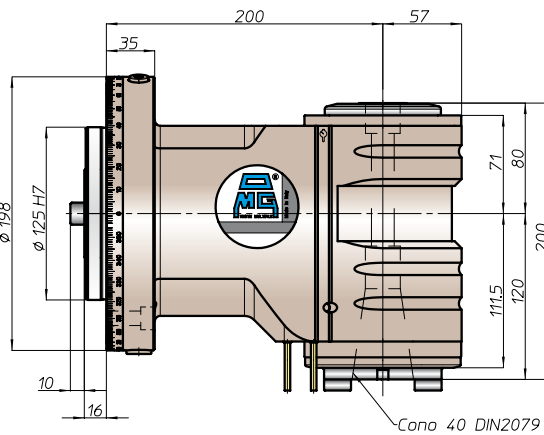
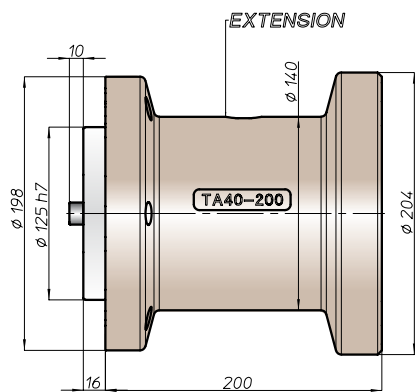
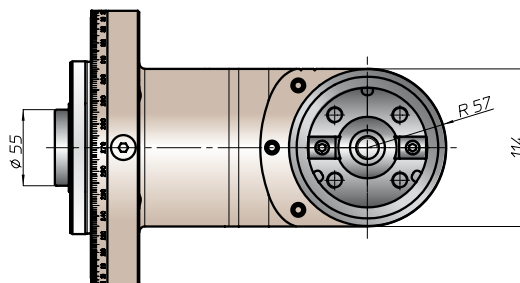

Cono 40 DIN2079

Equipaggiamento standard:

- pressurizzazione mandrino
- n. 3 ugelli orientabili vicino al mandrino
- nel mandrino DIN2079 si possono utilizzare coni DIN2080-40, DIN69871-A40, MAS403-BT40

Standard equipment:

- spindle front pressurization
- nr 3 adjustable nozzle near the spindle
- on the spindle DIN2079 you can use shank DIN2080-40, DIN69871-A40, MAS403-BT40

esempio di collegamento - connection example

