

# TA26.40



caratteristiche/features

peso/weight

prestazioni/performance



22 kg

rotazione/rotation

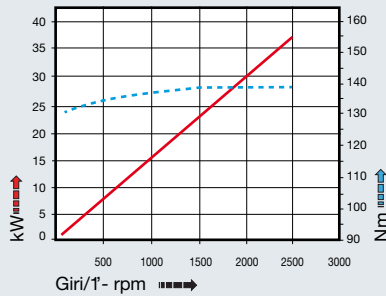

CONO SHANK	size	A	B	H	
				standard	optional
* DIN69871 *	-	192	35	-	-
	45			110	-
	50			110	-
* ANSIB5.50 *	CAT	-	-	-	-
	50	-	-	110	-
* BT	-	-	-	-	-
	50	200	45	110	-
HSK	-	-	-	-	-
	DIN69893	80	201	46	110
	100	-	-	-	-
CAPTO	-	196	-	-	-
	ISO26623		-	110	-
KM	-	192	-	-	-
	100		110	-	
DIN2080	-	165	16	110	-
	50		-	-	-
ANSIB5.18 NMTB	-	165	16	110	-
	50		-	-	-

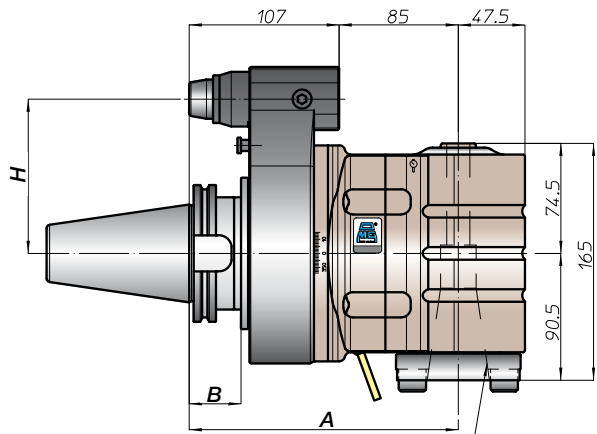
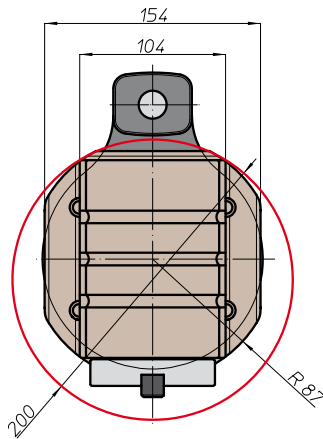

Cono 40 DIN2079

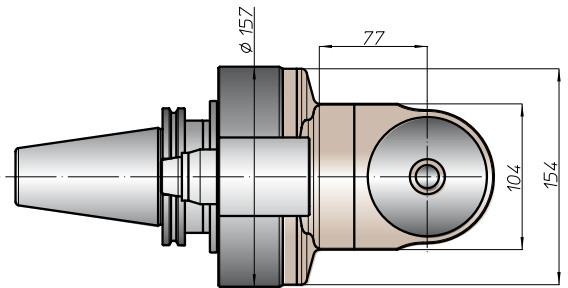

**Nota:**

- nel mandrino DIN2079 si possono utilizzare coni DIN2080-40, DIN69871-A40, MAS403-BT40

**Note:**

- on the spindle DIN2079 you can use shank DIN2080-40, DIN69871-A40, MAS403-BT40

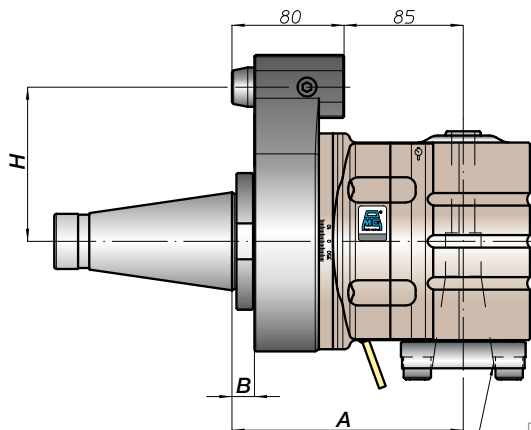

Cono 40 DIN2079

\* Option: Dual Contact